

THIS DRAWING IS UNPUBLISHED. RELEASED FOR PUBLICATION, 19 .
 © COPYRIGHT 19 BY AMP INCORPORATED. ALL INTERNATIONAL RIGHTS RESERVED.

LOC	DIST	P	F	REVISIONS				
				ZONE	LTR	DESCRIPTION	DATE	APPD
CM	52				E	REV & REDWN PER EC 0730-0059-95	3-21-95	KS RS

- ① 0.00076 [.000030] MIN GOLD OVER
0.00127 [.000050] MIN NICKEL.
- 2. DIMENSIONS IN BRACKETS ARE IN INCHES.

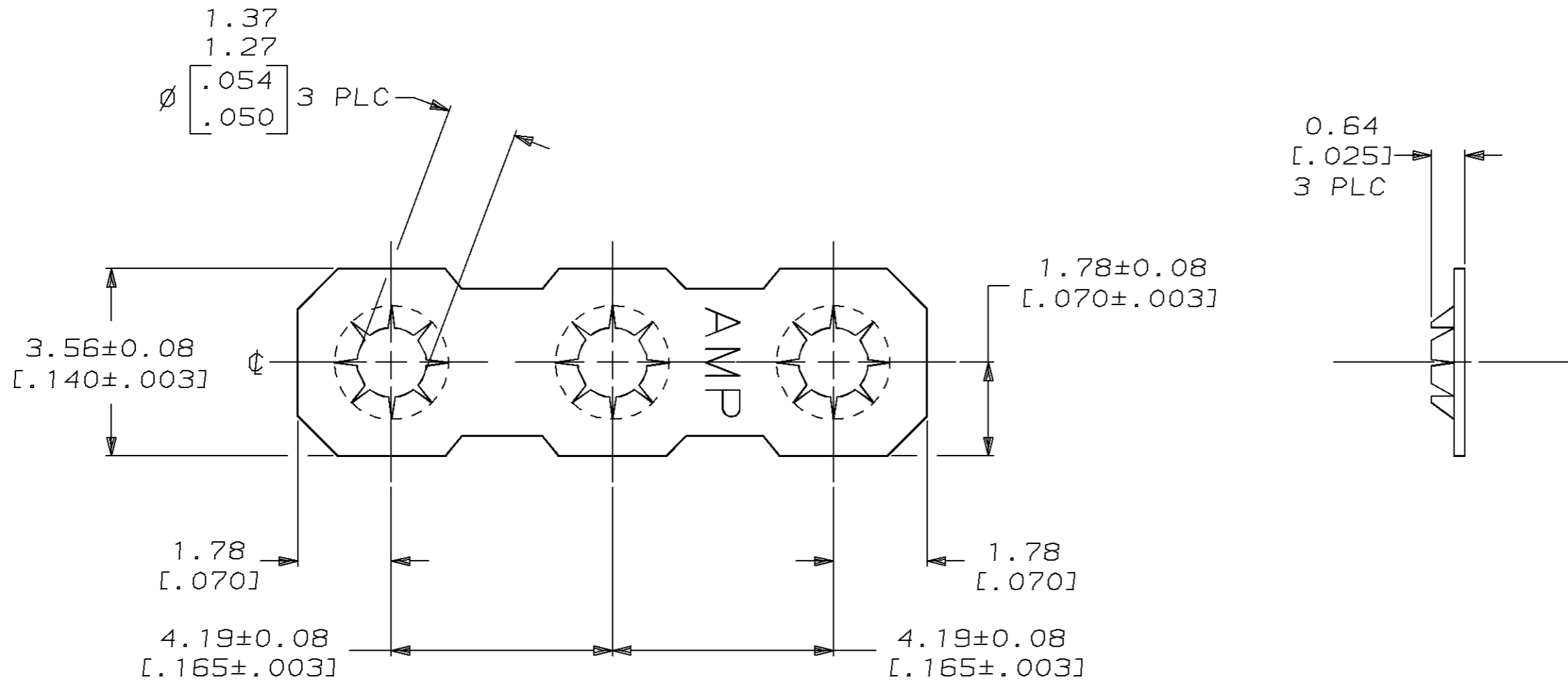

FINISH	MATERIAL	PART NO
GOLD ①	0.20 [.008] BRASS	350021-2
PRE-TIN	0.20 [.008] BRASS	350021-1

METRIC

THIS DRAWING IS A CONTROLLED DOCUMENT FOR AMP INCORPORATED. IT IS SUBJECT TO CHANGE AND THE CONTROLLING ENGINEERING ORGANIZATION SHOULD BE CONTACTED FOR THE LATEST REVISION.

DO NOT SCALE PRINT. UNLESS SPECIFIED DIMENSIONS IN mm [INCHES] TOLERANCES ON: 2 PLC DEC ± 0.13 [.005] 3 PLC DEC ± - ANGLES ± -	DR 3-21-95 K. SALMON	AMP AMP Incorporated Harrisburg, PA 17105-3608
	CHK 3-21-95 R. SWING	
	APPD 3-21-95 W. LONG	
	APPD 3-21-95 W. LONG	
MATERIAL SEE TABLE	PRODUCT SPEC -	NAME COMMONING BAR, 3 POSITION
FINISH SEE TABLE	APPLICATION SPEC -	SIZE B
	WEIGHT -	CAGE CODE 00779
		DRAWING NO C-350021
		SCALE 10:1
		SHEET 1 OF 1